

* RoHS Compliance

ELECTRICAL CHARACTERISTICS :

1.DCR : PIN 1-4 = 0.6Ω MAX.(2+3 SHORT)
PIN 8-5 = 0.12Ω MAX.

2.Inductance (@10kHz; 0.1Vrms)
PIN 1-4 (2+3 SHORT) = 400uH ±10%

3.Leakage Inductance (@100kHz; 0.1Vrms)
PIN 1-4 (2+3 ; 5+8 SHORT) = 1.8uH MAX.

4.Interwinding Capacitance (@100kHz; 0.1Vrms)
PIN 1-8 (2+3 SHORT) = 55pF MAX.

5.TURN RATIO (@20kHz; 0.1Vrms):
PIN 1-4 : PIN 8-5 (2+3 SHORT)= 4 : 1 ±2%

6.HI-POT :
(1875VAC, 5mA, 2SEC) PIN 1-8 (PIN 2+3 SHORT)

7.Operating Temperature Range : -40°C~85°C

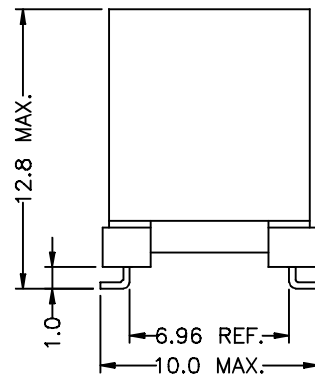
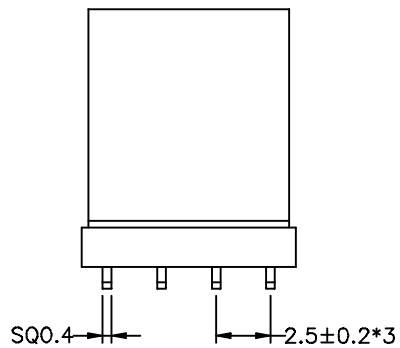

							TITLE VDSL2 TRANSFORMER	
							DWG. NO. ATS-1618R	
RELEASE					UNITS:	SAFETY		SHEET 1 of 1
NO:	DESCRIPTION	DATE	BY	CHK	APPD	DATE	P/N:	DRAW
REVISIONS								